

HC 200 SERIES

Normal-Duty Ball Bearing
Eccentric Lock

TURNER
Mounted Bearings

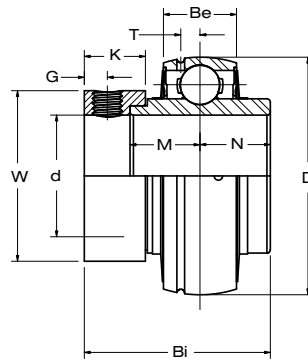

Available Seal Styles:

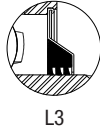

Bearing Insert	Shaft Dia. d in. mm.	Setscrew Used in. mm.	Dimensions in. mm.									Load Rating lbs. kN.		Weight lbs. kg.
			D	Bi	Be	N	M	T	W	K	G	Dynamic C _r	Static C _{0r}	
HCW 201	12	M6 x 1	1.5748 40.0	1.4685 37.3	0.5512 14.0	0.5472 13.9	0.5472 13.9	0.1496 3.8	1.126 28.6	0.531 13.5	0.1969 5.0	2,147 9.55	1,075 4.78	0.3 0.1
HCW 201-8	1/2	1/4-28												
HCW 202	15	M6 x 1												
HCW 202-10	5/8	1/4-28												
HCW 203	17	M6 x 1	1.8504 47.0	1.7205 43.7	0.6693 17.0	0.6693 17.1	0.6732 17.1	0.1457 3.7	1.311 33.3	0.532 13.5	0.1969 5.0	2,883 12.82	1,496 6.65	0.5 0.2
HC 201	12	M6 x 1												
HC 201-8	1/2	1/4-28												
HC 202	15	M6 x 1												
HC 202-10	5/8	1/4-28												
HC 203	17	M6 x 1												
HC 204-12	3/4	1/4-28												
HC 204	20	M6 x 1	2.0472 52.0	1.7480 44.4	0.6693 17.0	0.6890 17.5	0.6850 17.4	0.1535 3.9	1.500 38.1	0.532 13.5	0.1969 5.0	3,155 14.04	1,810 8.05	0.6 0.3
HC 205-14	7/8	1/4-28												
HC 205-15	15/16	1/4-28												
HC 205	25	M6 x 1												
HC 205-16	1	1/4-28	2.4409 62.0	1.9055 48.4	0.7480 19.0	0.7205 18.3	0.7165 18.2	0.1969 5.0	1.752 44.5	0.626 15.9	0.2362 6.0	4,377 19.47	2,569 11.43	0.9 0.4
HC 206-17	1 1/16	1/4-28												
HC 206-18	1 1/8	1/4-28												
HC 206	30	M6 x 1												
HC 206-19	1 3/16	1/4-28												
HC 206-20	1 1/4	1/4-28												
HC 207-20	1 1/4	5/16-24	2.8346 72.0	2.0118 51.1	0.7874 20.0	0.7402 18.8	0.7402 18.8	0.2244 5.7	2.189 55.6	0.688 17.5	0.2559 6.5	5,775 25.69	3,497 15.56	1.3 0.6
HC 207-21	1 5/16	5/16-24												
HC 207-22	1 3/8	5/16-24												
HC 207	35	M6 x 1												
HC 207-23	1 7/16	5/16-24	3.1496 80.0	2.2165 56.3	0.8268 21.0	0.8425 21.4	0.8425 21.4	0.2520 6.4	2.375 60.3	0.721 18.3	0.2559 6.5	6,634 29.51	4,079 18.14	1.7 0.8
HC 208-24	1 1/2	5/16-24												
HC 208-25	1 9/16	5/16-24												
HC 208	40	M8 x 1												
HC 209-26	1 5/8	5/16-24	3.3465 85.0	2.2165 56.3	0.8661 22.0	0.8425 21.4	0.8425 21.4	0.2520 6.4	2.500 63.5	0.721 18.3	0.2559 6.5	7,160 31.85	4,676 20.80	1.8 0.8
HC 209-27	1 11/16	5/16-24												
HC 209-28	1 3/4	5/16-24												
HC 209	45	M8 x 1												
HC 210-30	1 7/8	5/16-24	3.5433 90.0	2.4685 62.7	0.9449 24.0	0.9685 24.6	0.9685 24.6	0.2559 6.5	2.752 69.9	0.721 18.3	0.2559 6.5	7,867 35.00	5,330 23.71	2.2 1.0
HC 210-31	1 15/16	5/16-24												
HC 210	50	M8 x 1												
HC 210-32	2	5/16-24												
HC 211-32	2	3/8-24	3.9370 100.0	2.8110 71.4	0.9843 25.0	1.0943 27.8	1.0906 27.7	0.2756 7.0	3.000 76.2	0.815 20.7	0.3153 8.0	9,743 43.34	6,608 29.40	3.0 1.4
HC 211-34	2 1/8	3/8-24												
HC 211	55	M10 x 1.25												
HC 211-35	2 3/16	3/8-24												
HC 212-36	2 1/4	3/8-24	4.3307 110.0	3.0630 77.8	1.0630 27.0	1.22065 31.0	1.2165 30.9	0.2992 7.6	3.315 84.2	0.878 22.3	0.3150 8.0	10,720 47.69	7,516 33.43	4.1 1.9
HC 212	60	M10 x 1.25												
HC 212-38	2 3/8	3/8-24												
HC 212-39	2 7/16	3/8-24												
HC 213-40	2 1/2	3/8-24	4.7244 120.0	3.3740 85.7	1.1024 28.0	1.3425 34.1	1.3425 34.1	0.3504 8.9	3.386 86.0	0.925 23.5	0.3346 8.5	12,859 57.20	8,994 40.01	4.6 2.1
HC 213	65	M10 x 1.25												
HC 214-43	2 11/16	3/8-24	4.9213 125.0	3.3740 85.7	1.1417 29.0	1.3425 34.1	1.3425 34.1	0.3504 8.9	3.543 90.0	0.925 23.5	0.3346 8.5	13,981 62.19	9,869 43.90	5.1 2.3
HC 214-44	2 3/4	M10 x 1.25												
HC 214	70	3/8-24												
HC 214-47	2 15/16	3/8-24												
HC 215	75	M10 x 1.25	5.1181 130.0	3.6260 92.1	1.1811 30.0	1.4685 37.3	1.4685 37.3	0.3504 8.9	4.016 102.0	0.925 23.5	0.3346 8.5	14,974 66.61	10,757 47.85	5.5 2.5
HC 215-48	3	3/8-24												